

CUST. MODEL:	REF.
CUST. P/N	DWG FILE:

DESCRIPTION CONTROL			
REV.	DESC.	DATE	APP.

SPFCIFICATIONS

Current Rating:

1.0 Amp

Insulator Resistance:

1000 Megohms min.

Contact Resistance:

25 m ohms max.

Dielectric withstanding:

AC 500V/minute

Operating Temperature:

-40°C to +105°C

Contact Material:

Brass

Insulator Material:

High Temperature Thermoplastic

+Glass Fibre UL94V-0

Color: Black

Finish:

Gold, Tin or Duplex plated

Standard: Gold flash all over

Duplex plating:

Gold plated on contact area

Tin on solder area

RoHS Compliance

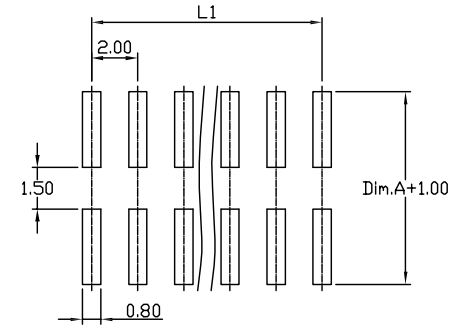
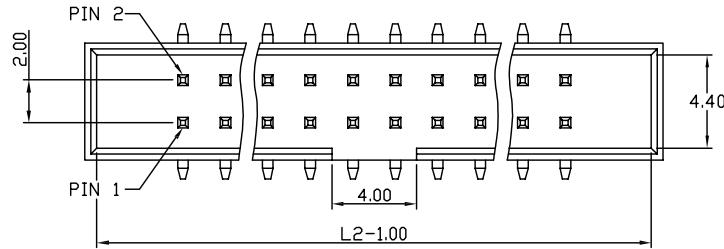

RECOMMENDED P.C.B LAYOUT

Cir-cuits	Dimension (mm)	
	L1	L2
2x3	4.00	13.20
2x4	6.00	15.20
2x5	8.00	17.20
2x6	10.00	19.20
2x7	12.00	21.20
2x8	14.00	23.20
2x10	18.00	27.20
2x12	22.00	31.20
2x13	24.00	33.20
2x15	28.00	37.20
2x17	32.00	41.20
2x20	38.00	47.20
2x22	42.00	51.20
2x25	48.00	57.20
2x34	66.00	75.20

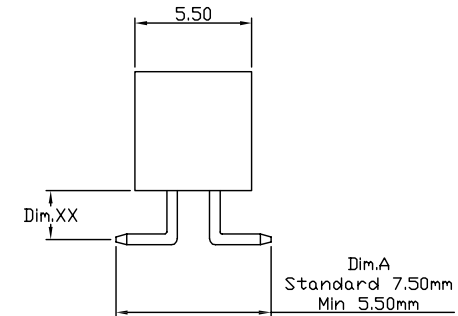
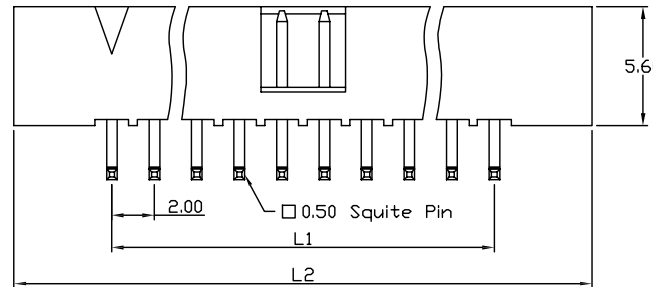

BH N B-20 M XX 2 XX-01G-56 0 - XX

N: Nylon-6T
 Color
 Pitch 2.0
 SMT Type
 Square Pin
 Row of Pin
 Number of Contact
 Dim.XX
 0: Without Post
 Plastic High 56:5.6
 G: Gold Plated
 T: Tin Plated
 H: Duplex Plated
 Contact Plating
 01 Normal
 03 3u"
 :
 :

UNLESS OTHERWISE SPECIFIED SURFACE FINISH ALL OVER TOLERANCES mm METRIC .X = ±0.38 .XX = ±0.25	DRAW:	DATE:	TITLE:
	CHUBBY	01/10/07	2.0 Box Header SMT Type Plastic High 5.6
	CHECK:	APPROVE:	MODEL CODE:
	KEVIN	TONY	BHNB-20M052XX-01G-560-10
			誠州電子有限公司 <i>Sincere State Electronics Co.,Ltd.</i>

NO	DESCRIPTION	QTY